



# *The Gallery* Events Space

---

A multi-use events space in the heart of  
ANU's Cultural Precinct

# Kambri at ANU

---

The Kambri Precinct at The Australian National University (ANU) offers a unique collection of world-class spaces with capabilities of hosting a versatile range of events.

We offer a unique experience to suit your every need, whether it be a private, public or corporate event, concerts, banquets, conferences, annual general meetings, workshops, presentations or product launches.

Kambri at ANU is becoming not just the heart of a thriving campus, but also the heart of the city it embodies.

## About *The Gallery*

---

*The Gallery* – is a social enterprise and creative place making business that thrives on operating outside the parameters of a traditional gallery. The Gallery hosts corporate, cultural activities, and commercial impulses that engage and entertain audiences, provide sustainable futures and establish a strong presence for their clients.

The Gallery is situated in Kambri which is the heart of The Australian National University. Kambri at ANU is becoming not just the heart of a thriving campus, but also the heart of the city it embodies.



# *The Gallery* Events Space

---

**A multi-use gallery and events space in the heart of ANU's Cultural Precinct**

Located on the second floor of Kambri at ANU's Cultural Centre - you'll find *The Gallery*.

This multi-use space doubles as a gallery and events space, with wall-to-ceiling windows, a balcony with breathtaking sunsets, and superb views of Kambri, ANU and Telstra Tower.

*The Gallery* provides a unique offering for cocktail and networking-style events in an active gallery environment. It's a malleable events space, able to host sit-down dinners, awards nights, parties, presentations, meetings, weddings, product launches and more.

You are welcome to select a caterer of your choice, and we are happy to provide recommendations on request.

*The Gallery* is fully accessible, with an underground car park that leads directly into the gallery.



# Venue Info

---

## **Location**

Level 2, Cultural Centre, University Ave,  
Kambri ANU  
[Google Maps](#)

## **Size**

Gallery Space: 192m<sup>2</sup>  
Outdoor Balcony: 192m<sup>2</sup>  
Ceiling Height: 3.85m

## **Capacity**

Standing: 150  
Sit Down Dinner: 70  
Cabaret: 56  
Boardroom: 40

## **Parking**

Access to the single level, underground car park is available at discounted rates for events packages. The car park includes in excess of 300 spaces, elevator access directly into *The Gallery*, and two pedestrian access points.

3 hours FREE parking on weekends. More information on the Care Park [Website](#).

# The Gallery

## Facilities & Services

The Venue is equipped with the following facilities and services that are included in the Venue Hire Fee:

- Direct access from carpark lift
- Basic set Up for event type
- 2x JBL PRX712W 12” Two-Way Full-Range PA Speaker
- 1x JBL PRX815XLFW 15” Powered Subwoofer w
- 2x Pioneer XDJ1000MK2 Media Player / Controller
- Mixer Pioneer DJM750MK2 4-Channel DJ Mixer w/Club DNA
- 1 x wired microphone

## Audio Visual Features

The Venue is compatible with the following audio visual equipment that can be hired for your event:

- 1 x Panasonic 5500LM Projector
- QU-16 Rack Mountable Digital Mixer
- Wireless microphones

\*staffing and accessories are costed separately.

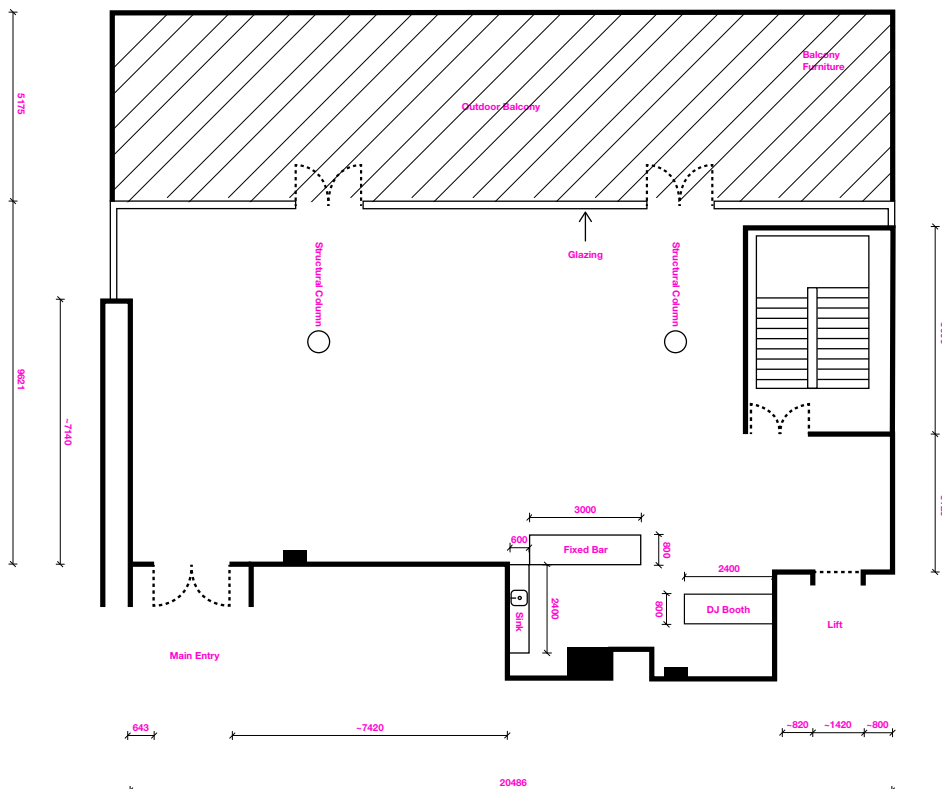

# Contact Details



## **Kambri Venues**

**p** 02 6215 6479

**e** [kambri.venues@anu.edu.au](mailto:kambri.venues@anu.edu.au)

